

NIGHTHAWK ESTATES

SEVEN LUXURY ESTATE LOTS

TOTALING 7.98 ACRES

NIGHTHAWK RD, SOUTH PALM DESERT AREA

Desert Pacific
PROPERTIES, INC.
COMMERCIAL REAL ESTATE

PROPERTY DESCRIPTION

Beautiful. Unparalleled. Otherworldly.

Nighthawk's limited collection of homesites is unlike any other.

Each lot is carefully situated to take full advantage of views, maximize privacy, and allow room for a multitude of luxurious amenities. Dictated by the land, the sites are interwoven between natural rock outcroppings and varying elevations.

Preserved open space envelops this exclusive community, with Stone Eagle's verdant fairways just moments to the north. From the thousands of lights that twinkle after sunset in the valley below, to dramatic vistas of the Santa Rosa and San Jacinto Mountains National Monument, Nighthawk presents a gorgeous backdrop for sophisticated living both day and night.

A private community within a private community, and protected by Stone Eagle's high-end gates and security detail, the Nighthawk homesites embody and enhance the raw features of the land and its unique lifestyle opportunities provided by the weather, culture, and geography of the Coachella Valley.

Welcome to Nighthawk, where a one-of-a-kind collection of homesites shares an other-worldly setting high in the majestic hills overlooking Palm Desert's prestigious southern valley.

nighthawkestates.com



NIGHTHAWK
ESTATES

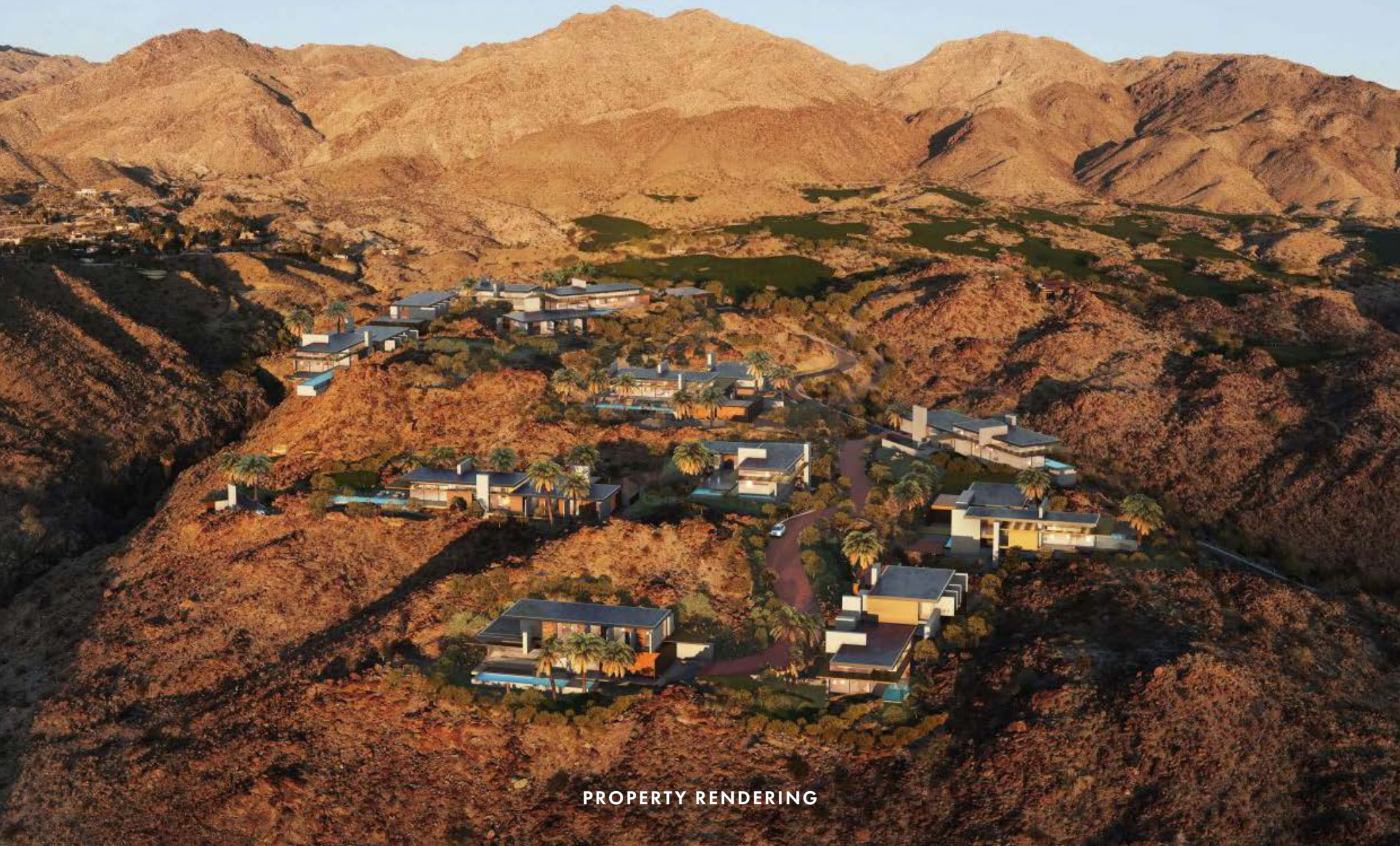

PROPERTY FEATURES

- A private enclave of luxury estate lots behind the gates of Stone Eagle ranging in size from 0.60 acre to 1.62 acres, all with unrivaled views
- The property is situated in Cahuilla Hills in the desirable south Palm Desert area, and is adjacent to the exclusive Stone Eagle Golf Club
- Each lot has been skillfully graded with all underground utilities to the site
- Minutes away from the renowned El Paseo Shopping District, home to Gucci, Louis Vuitton, Saks Fifth Avenue, Mastro's Steakhouse, and more
- Positioned amidst the scenic desert landscape, the property's secluded location offers optimum privacy and stellar mountain vistas
- Surrounded by prestigious, exclusive communities such as Bighorn Golf Club, Ironwood Country Club, and The Reserve Club
- Contact broker for pricing

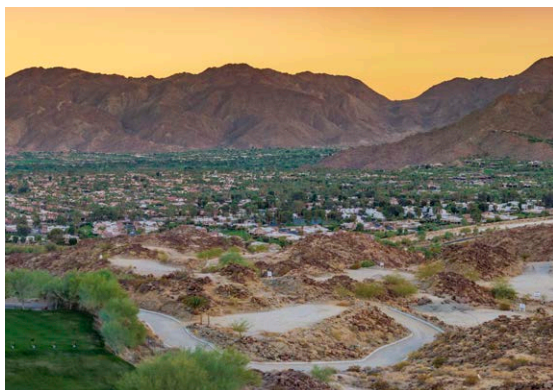

BIGHORN

Bighorn Golf Club is a world-renowned exclusive country club and golf course set amidst stunning terrain in South Palm Desert.

ADJACENT PROPERTY
BIGHORN COUNTRY CLUB



Stone Eagle Golf Club is a private golf club located within the Santa Rosa & San Jacinto Mountains National Monument, surrounded by thousands of acres of protected land.

**ADJACENT PROPERTY
STONE EAGLE GOLF CLUB**

SITE OUTLINE



NIGHTHAWK

ESTATES

SITE DETAILS:

- **Location:** Nighthawk Estates is located on the south side of Stone Eagle Drive just west of Highway 74 in the unincorporated community of Cahuilla Hills, CA.
- **Zoning:** R-1-1 (One Family Dwellings)
- **General Plan:** RC-VLDR (Rural Community, Very Low Density Residential)
- **Utilities:** Electric: To site
Water: 8" line to site
Sewer: 8" line to site
- **HOA Dues:** \$430/month
- **Lot Size:** Total size - 7.98 acres
For individual lot sizes, see table below.
- **Comments:** This is an amazing opportunity to acquire a one-of-a-kind estate tract with unrivaled views behind the gates of Stone Eagle. This captivating setting will take you to a place where you can refresh, relax and leave your worries behind in a world that feels a million miles away from the hustle and bustle, yet is just a five minute drive to the fine dining and shopping of the acclaimed El Paseo Drive. Each lot has been artistically graded with all utilities underground to the site, designed to harmonize with nature and blend in seamlessly with the surroundings. The Santa Rosa Mountains form a unique enclave that offers privacy, beauty, and tranquility.

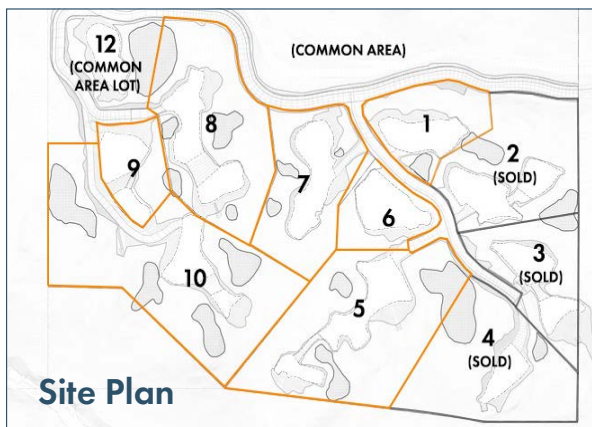

LOT DESCRIPTIONS

Lot No.	Parcel No.	Buildable Footprint	Pad Size	Lot Size
1	628-350-049	7,516 SF	15,031 SF	26,712 SF (0.61 AC)
5	628-350-053	9,350 SF	12,601 SF	70,567 SF (1.62 AC)
6	628-350-054	5,325 SF	8,404 SF	26,136 SF (0.60 AC)
7	628-350-055	7,550 SF	15,100 SF	41,959 SF (0.96 AC)
8	628-350-056	9,940 SF	19,880 SF	61,750 SF (1.42 AC)
9	628-350-057	9,350 SF	18,700 SF	60,789 SF (1.40 AC)
10	628-350-058	6,350 SF	12,700 SF	59,677 SF (1.37 AC)

LOCATION OVERVIEW

SOUTH PALM DESERT/ CAHUILLA HILLS

Palm Desert's outstanding quality of life offers residents and visitors a wide array of recreational, educational, shopping, housing, and entertainment opportunities as well as arts and cultural activities and world-class events in a uniquely beautiful desert environment. This premier resort destination is a thriving, safe, and sustainable community ringed by three magnificent mountain ranges, which shelter the City from coastal air pollution and inclement weather. With 350 days of sunshine a year, Palm Desert is beautiful all year long.

The City of Palm Desert is home to the renowned El Paseo Shopping District, a tree-lined boulevard boasting public art pieces, upscale stores, boutiques, and restaurants. It is known as the "Rodeo Drive of the Desert" for its luxury departments stores and designer brands, such as Saks Fifth Avenue, Tiffany & Co, Louis Vuitton, Gucci, & Ralph Lauren to name a few.



LUXURY DEVELOPMENT HOME SALES IN THE AREA

DEVELOPMENT	AVG PRICE PSF
BIGHORN GOLF CLUB	\$1017/SF
MIRADA ESTATES	\$712/SF
THE RESERVE	\$814/SF
THUNDERBIRD HEIGHTS	\$761/SF
VINTAGE CLUB	\$722/SF

CONTACTS & DISCLOSURE

Desert Pacific
PROPERTIES, INC.
COMMERCIAL REAL ESTATE

BROKERS / AGENTS



SUSAN HARVEY
Owner/Broker Associate
susan@dppllc.com
Cell 760-250-8992
DRE #00957590



CLAIRE HARVEY
Agent
clairekharvey@gmail.com
Cell 760-636-3501
DRE #02198860



EMILY HARVEY
Agent
emily@dppllc.com
Cell 760-636-3500
DRE #02229612

DISCLOSURE

The information contained herein is proprietary and strictly confidential. It is intended to be reviewed only by the party receiving it from Desert Pacific Properties and should not be made available to any other person or entity without the written consent of Broker. The Materials have been prepared to provide summary, unverified information to interested parties, and to establish only a preliminary level of interest in the subject property. Broker, as a Real Estate Licensee is not qualified to discuss or advise on legal, accounting, or other matters outside of those permitted by state law. Broker has not made any investigation, and makes no warranty or representation, with respect to the future projected financial performance of the property, the acreage, square footage or unit count of the property and improvements, the compliance or non-compliance with the City, County, State and/or Federal regulations, or the physical condition of the improvements thereon. The information contained in this brochure (also referred to as an Offering Memorandum) has been obtained from sources that we believe to be reliable, however, Broker has not verified, and will not verify, any of the information contained therein, nor has broker conducted an investigation regarding these matters and makes no warranty or representation whatsoever regarding the accuracy or completeness of the information provided. All interested parties must take appropriate measures to verify all of the information set forth herein. All references to Broker include its officers, partners, agents, sub-agents, and employees. Buyer and the Seller of subject property acknowledges that Desert Pacific Properties, may act as an agent for both the Buyer and the Seller on the subject property. Any prospective Buyer or Seller acknowledges the foregoing disclosures and agrees to the described agency relationships with other prospective Buyers and Sellers.

Desert Pacific Properties
44267 Monterey Ave, Suite A
Palm Desert, CA 92260
DesertPacificProperties.com
DRE#01420416

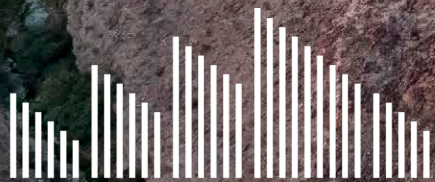

Desert Pacific
PROPERTIES, INC.
COMMERCIAL REAL ESTATE